



EFPB Series

EVOTEK High Pressure Filters

Product Description

- Operating pressure up to 315 bar
- 120 l/min max. flow rate
- installation in pressure line
- application in Power units, Machine tools, Die Casting and agricultural machines
- compliant with industry relevant ISO standards(see ISO test below)

Technical Specifications

Application

Port Sizes:

Flow Rate:

Operating Pressure:

Burst Pressure:

Element Collapse Pressure:

By-pass Opening Pressure:

Material

Seals:

Filter Head:

Filter Bowl:

Compatibility:

Tested according to ISO standards:

Inline High Pressure Filter

Threaded Connections according to BSP and NPT standard in ½ " to ¾" and SAE08/SAE12 threads

max. 120 l/min

max. 315 bar

min. 950 bar

10 bar (P series), 21 bar (M series), 30bar (Y series)

$\Delta p = 6 \text{ bar} + 0.6 \text{ bar}$

NBR or FPM (-10°C to 100°C)

S.G. cast iron

forged steel

Suitable for mineral oils, lubrication oils, non-flam fluids, synthetic and rapidly biodegradable oils (for use with water or other fields please contact our technical department)

ISO2941 Collapse/burst resistance

ISO2942 Fabrication integrity

ISO2943 Material compatibility integrity

ISO3723 Method for end load test

ISO3724 Flow fatigue characteristics

ISO3968 Pressure Drop vs. Flow Rate

ISO16889 Multi-Pass Test

EFPB High Pressure Filter Series

Pressure Drop Graphs (Δp)

Pressure Drop of Filter Housing only

EFPB1, 2 & 3

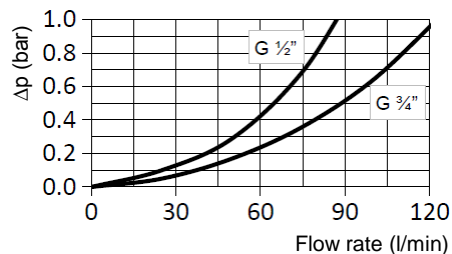

Graph of oil flow velocity

(we recommend to select size of the filter considering range of oil velocity between 3 to 12 m/s for pressure series)

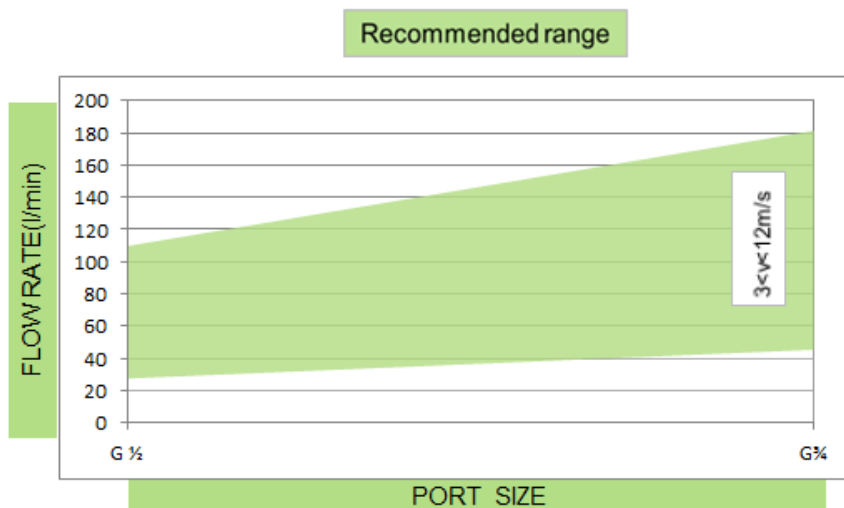

Pressure drop graph on by-pass valve

EFPB1, 2 & 3

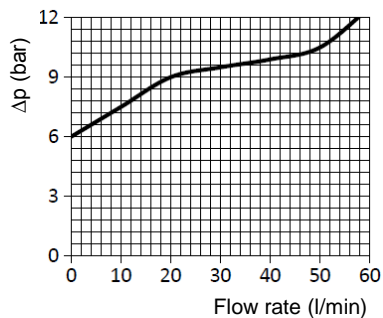

EFPB High Pressure Filter Series

Pressure Drop Graphs (Δp)

Pressure Drop with Clean Filter Elements (M and P filter media)

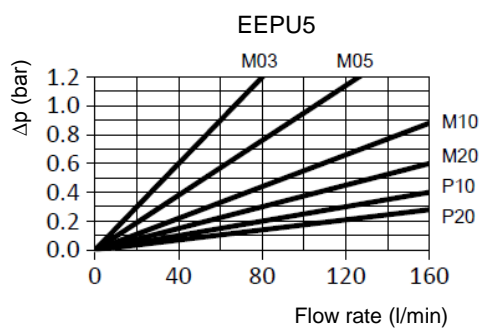
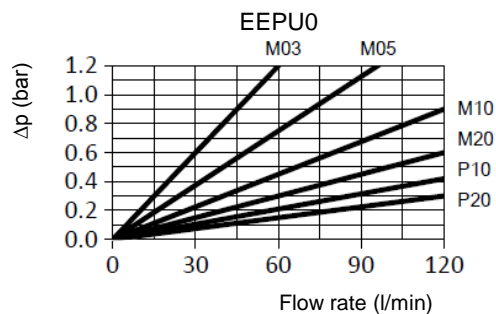
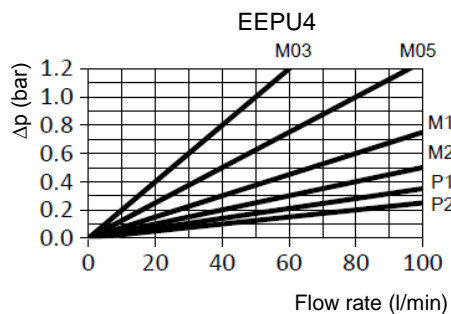

EFPB High Pressure Filter Series

Technical Drawings and Dimension

EFPB 1/2/3

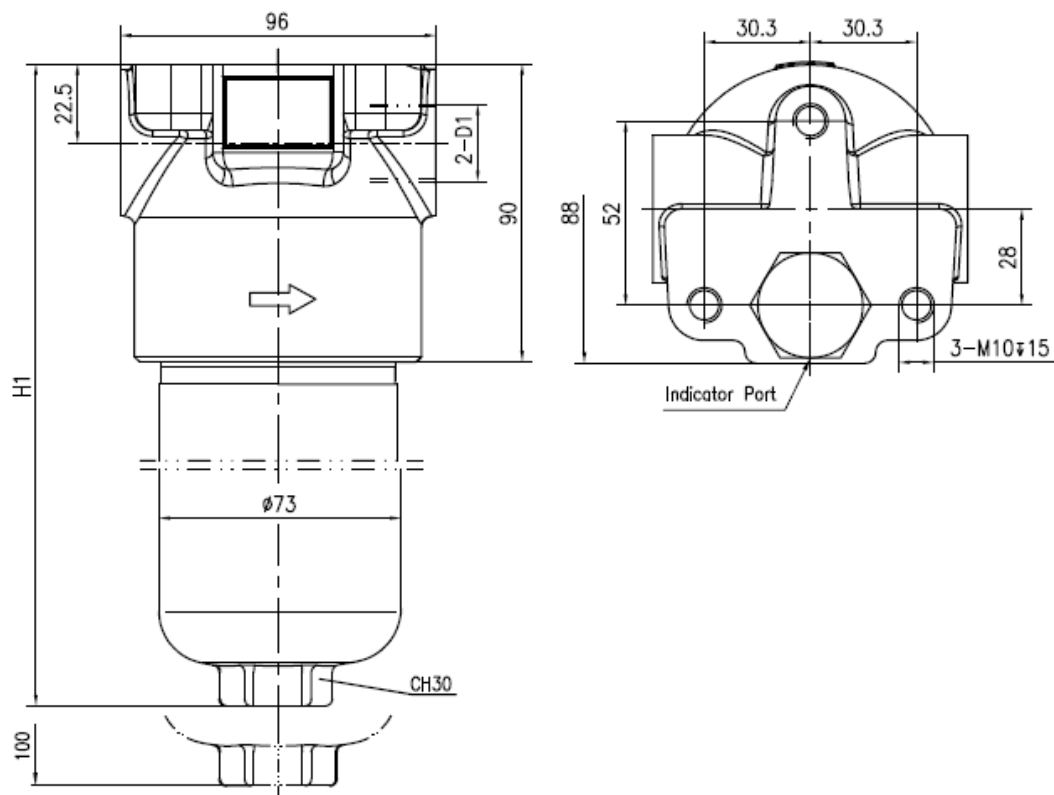

Threaded Connection Ports

Type	Connection Port (BSP/NPT/SAE)	Height
	inch	mm
EFPB1	D1 1/2"	202
EFPB2	3/4" SAE08	248
EFPB3	SAE12	298

EFPB High Pressure Filter Series

Order Codes

Filter Assembly	A	B	C	D	-	E	-	F	Element Series	A	D	E
EFPB	3	BC	00	B	-	M20	-	E50	EEPU	5	B	M20

Select the code for each filter (or element) feature according to your requirements and place it in the sequence (see example above) to create the corresponding product order code.

A	Size	Flow Rate	Element
1	80 l/min		EEPU4
2	100 l/min		EEPU0
3	120 l/min		EEPU5

B Connection Ports

A08	SAE08
A12	SAE12
BB	BSP ½"
BC	BSP ¾"
NB	NPT ½"
NC	NPT ¾"

C By-pass Valve

00	No
11	6.0 bar
X	special

D Seal

B	NBR
V	FPM

E Media Material			Filtration	Collapse Pressure
P10	Cellulose	10µm	10 bar	
P20	Cellulose	20µm	10 bar	
M03	Fibreglass	5µm	21 bar	
M05	Fibreglass	7µm	21 bar	
M10	Fibreglass	12µm	21 bar	
M20	Fibreglass	21µm	21 bar	
Y25	Wire Mesh	25µm	30 bar	
Y60	Wire Mesh	60µm	30 bar	

F Indicator

00	No	Connection
V50	5 bar visual	M20*1.5 Thread
E50	5 bar visual/electrical	M20*1.5 Thread
E50S	5 bar electrical	M20*1.5 Thread
E50T	5 bar electrical with thermostat (30°C)	M20*1.5 Thread

This image shows a single sheet of white paper with horizontal ruling lines. The lines are evenly spaced and run across the width of the page. There are no margins, text, or other markings on the paper.